

■ POWER STEERING VANE PUMP

A compact and lightweight vane pump, which uses die-cast aluminum as the material for its front and rear housings, is adopted for the 2KD-FTV engine model. By optimizing its internal construction, this vane pump has realized low-friction operation, which leads to low fuel consumption.

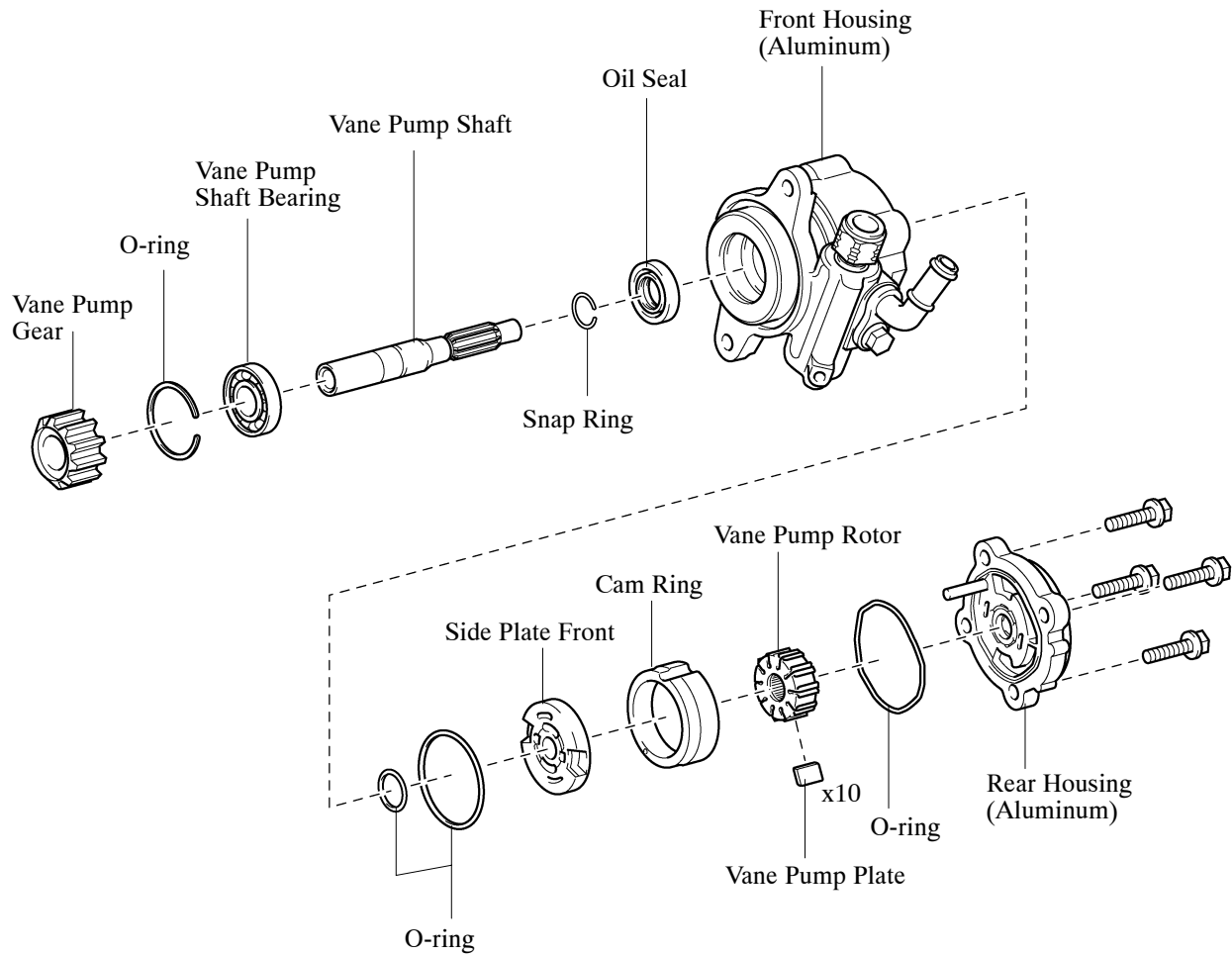

237CH24

► Specifications ◀

Model		New	Previous
Operation Speed	(rpm)	500 ~ 7000	500 ~ 7500
Theoretical Discharge Rate	(L/min at 1000 rpm)	8	←
Relief Pressure	[Mpa (kgf/cm <sup>2</sup> )]	8.8 (89.7)	←